



PROFILE

Formally a military chapel, the Central Hall has been used as a concert hall and event venue for the last 50 years. The perfect venue for parties, wedding receptions and large functions. It has recently undergone major refurbishment modernizing the Hall and improving the surrounding grounds too. The original stained-glass windows were rediscovered in this project and are being restored with new artwork commissioned.

CONTACT DETAILS

ADDRESS:

Gibraltar Cultural Services Ltd
Central Hall
13 North Pavilion road
Gibraltar, GX11 1AA

PHONE:

00350 200 75669

WEBSITE:

Culture.gi

EMAIL:

Bookings@culture.gov.gi

CENTRAL HALL

CONCERT VENUE & EVENT FACILITY

CAPACITY

350

OPENING HOURS

Available all day

AMENITIES

- Wi-Fi access
- Air Conditioning
- Sound system
- Bar
- Ice Machine
- Kitchen and food preparation area
- Cloakroom
- Kitchenette
- Toilet facilities (Ladies & Gents)
- 300 plastic chairs
- 35 trestle tables (1.8m)
- 19 Round Grey Tables
- Patio area
- Parking

FEES

Deposit: £500

Hiring Fees:

Birthdays and other minor celebrations: £200.00

Weddings and other large events (Kitchen use): £500.00

Ticketed Events (for Charities) : £200.00

Ticketed Events (for others) : *£500.00

*Including 20% on ticket sales.

SITE PLAN

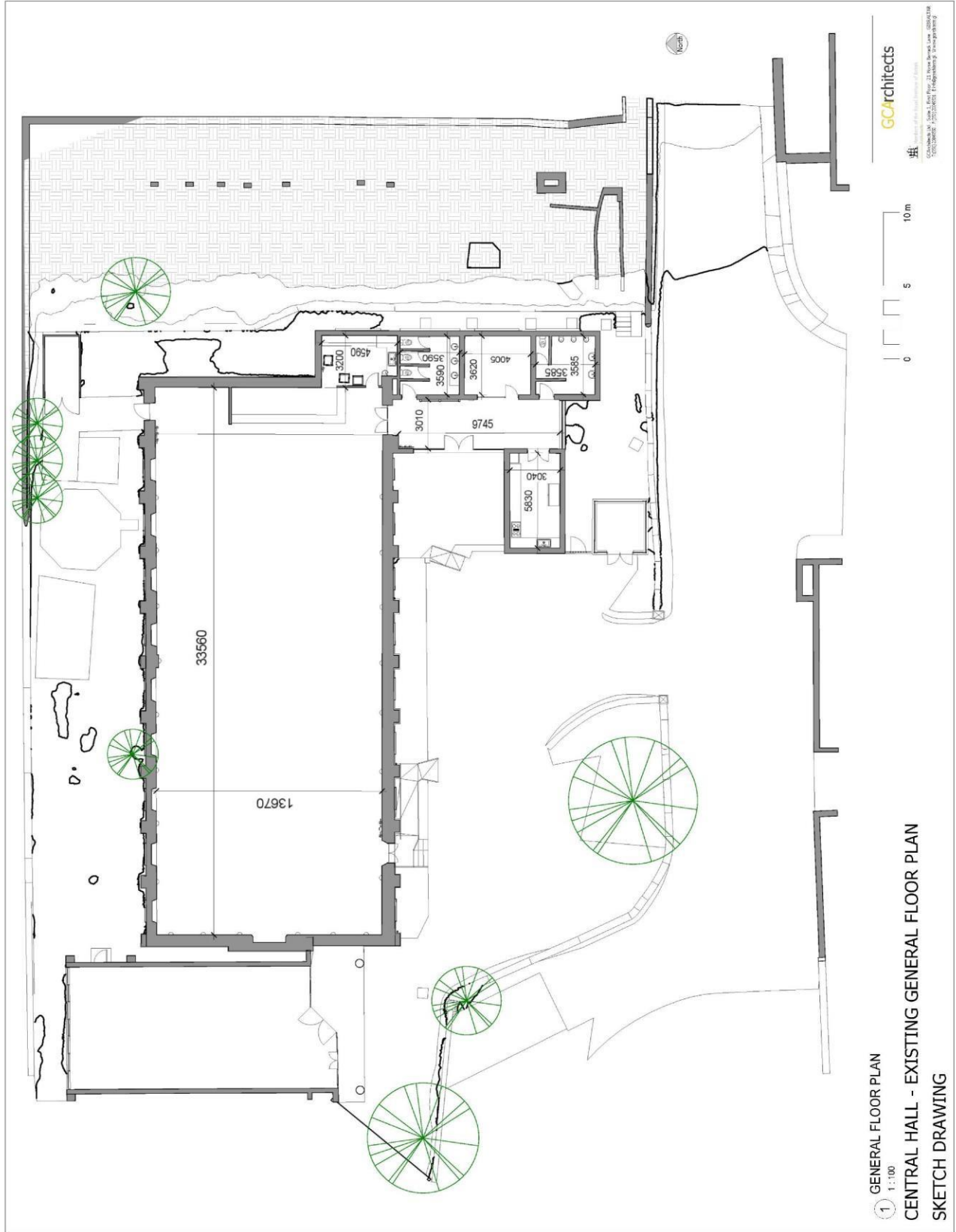

GCArchitects
GCArchitects GmbH, Finkenstr. 23, 10245 Berlin, Germany
Tel: +49 30 25202020 | Fax: +49 30 25202021 | Email: info@gca-architects.com

0 5 10 m

1 GENERAL FLOOR PLAN
1:100
CENTRAL HALL - EXISTING GENERAL FLOOR PLAN
SKETCH DRAWING